

# Transmission Lock



## Service Instructions

Model Number	Repair Kit Number
03-640-185 (BF)	02-600-013
03-640-186 (HO)	02-600-022

HO = Hydraulic Oil    BF = Brake Fluid

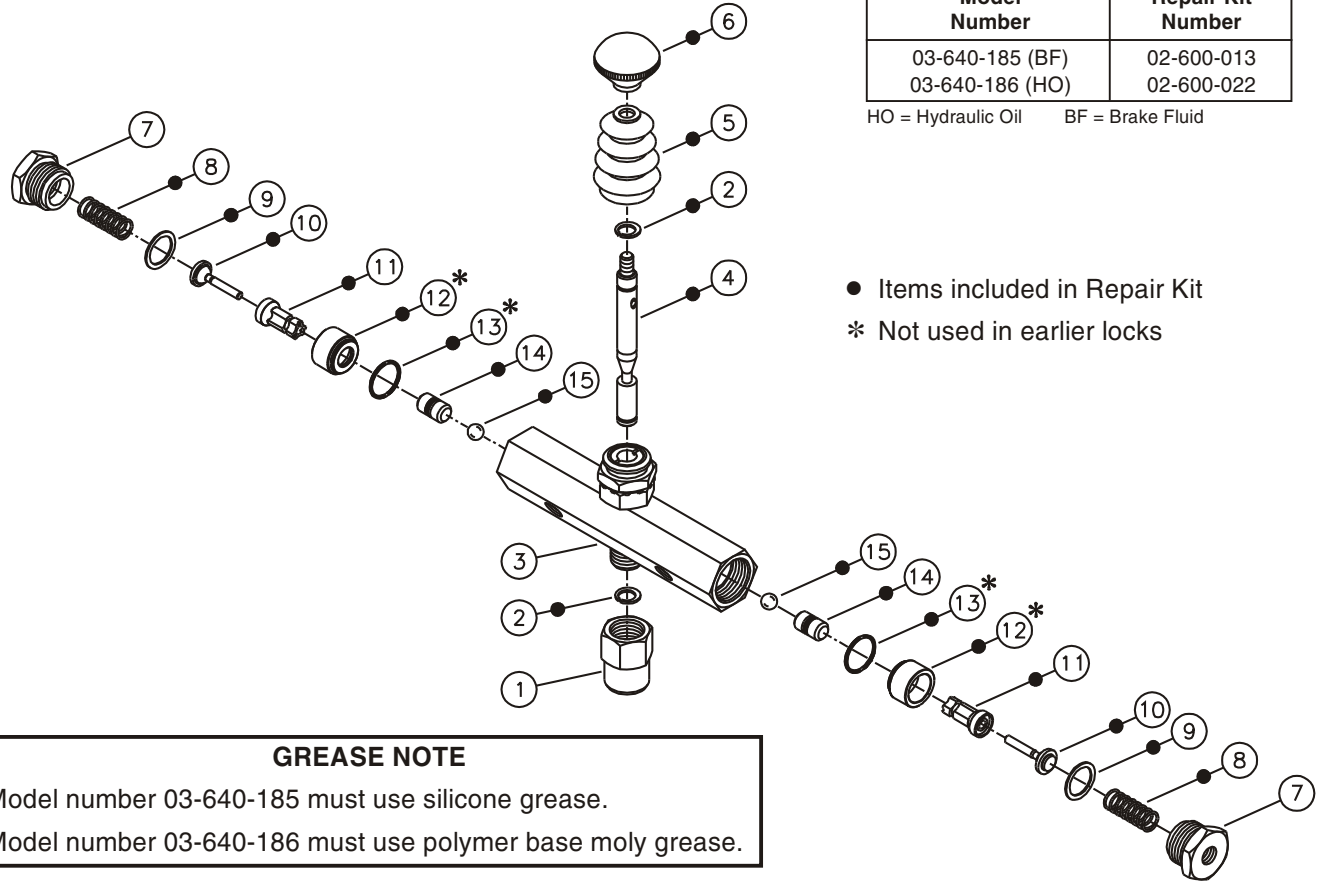

- Items included in Repair Kit
- \* Not used in earlier locks

**GREASE NOTE**

Model number 03-640-185 must use silicone grease.  
 Model number 03-640-186 must use polymer base moly grease.

### DISASSEMBLY

1. Remove end plug (7), spring (8), gasket (9), valve stem (10), valve (11), insert (12), and o-ring (13) from one side of housing (3). **NOTE: Earlier locks did not use insert (12) or o-ring (13).**
2. Repeat step 1 for other half of housing (3).
3. Remove end plug (1) from housing (3).
4. Push down on knob (6) and remove retaining ring (2) from bottom groove on push rod (4).
5. Pull up on knob (6) to remove entire push rod assembly from housing (3) and discard.
6. Using a wooden dowel, remove both piston assemblies (14) and both balls (15) from housing (3). **NOTE: Be careful not to scratch or mar housing bore.**

### ASSEMBLY

LUBRICATE ALL RUBBER COMPONENTS FROM REPAIR KIT WITH CLEAN TYPE FLUID USED IN THE SYSTEM.

1. Thoroughly clean housing and housing bore before assembly.
2. Install new retaining ring (2) in upper groove on new push rod (4).
3. Install new boot (5) and new knob (6) on new push rod (4).

4. Lubricate outer diameter and ramps of new push rod (4) with proper grease as indicated in GREASE NOTE. Install new push rod assembly in housing (3). Seat new boot (5) properly on housing.
5. Depress knob (6) and install new retaining (2) in bottom groove of new push rod (4).
6. Apply two drops of Loctite 242 to threads on bottom of housing (3). Install end plug (1) and torque 9.0-11.3 N-m (80-100 lb-in).
7. Install new ball (15) and new piston assembly (14) in housing (3). **Note: Back-up ring side of piston assembly (14) to face center of housing (3).**
8. Lubricate new o-ring (13) with proper grease as indicated in GREASE NOTE. Install new o-ring (13) in bottom of housing (3) bore. **NOTE: Earlier models did not use o-ring (13).**
9. Install new valve (11) in new insert (12). Install new valve stem (10) in new valve (11) and install this assembly in housing (3). **NOTE: Earlier models did not use insert (12).**
10. Install new gasket (9) and new spring (8) in housing (3).
11. Install end plug (7) in housing (3) and torque 63.7-71.9 N-m (47-53 lb-ft).
12. Repeat steps 7 through 11 for other half of housing (3).

This publication is not subject to any update service. Information contained in this publication was in effect at the time the publication was approved for printing and is subject to change without notice or liability. ZF Off-Highway Solutions Minnesota Inc. reserves the right to revise the information presented or to discontinue the production of parts described at any time.



**ZF Off-Highway Solutions Minnesota Inc.**  
1911 Lee Boulevard / North Mankato, MN U.S.A. 56003  
**Tel:** +1 507 625 6426 **Fax:** +1 507 625 3212