

PEDAL ACTUATED Modulating Valves



Switch Replacement Instructions

NOTE

This literature services various power brake valve models. The illustration shown in FIGURE 1 may appear different than your brake valve assembly.

SWITCH REPLACEMENT INSTRUCTIONS

(Refer to Figure 1)

NOTE

Clean the area near the switch of dirt, oil and debris. It may not be necessary to remove the valve or pedal and base assembly to replace the switch.

1. Unplug the wire harness connector.
2. Loosen nut (1) and remove from phillips head machine screw (2). Remove machine screw (2) from switch (4).
3. Remove slotted head machine screw (3) and switch assembly (4) from pedal and base assembly (5).
4. Apply a drop of Loctite 222 to the threads of slotted head machine screw (3). Install new machine screw (3) and new switch assembly (4).
5. Install new phillips head machine screw (2) and new nut (1). Use a drop of Loctite 222 on the threads of machine screw and torque nut (1) 0.23-0.57 N·m (2-5 lb·in) while holding machine screw (2).
6. Torque slotted head machine screw (3) 0.23-0.57 N·m (2-5 lb·in).
7. Check adjustment of switch assembly by placing a 0.052" +/- 0.002" thick shim between the pedal and pedal stop. The switch should "click", actuate. Verify that the switch resets when a 0.006" +/- 0.002" thick shim is placed between the pedal and pedal stop. If switch is not actuating as indicated, loosen nut on adjustment screw and rotate the bracket until adjustment is obtained. Retighten adjustment screw by torquing the nut 1.13-1.70 N·m (10-15 lb·in) while holding the screw.
8. Plug the connector in and check to be sure the new switch is functioning properly.

• Items included in Switch Kit

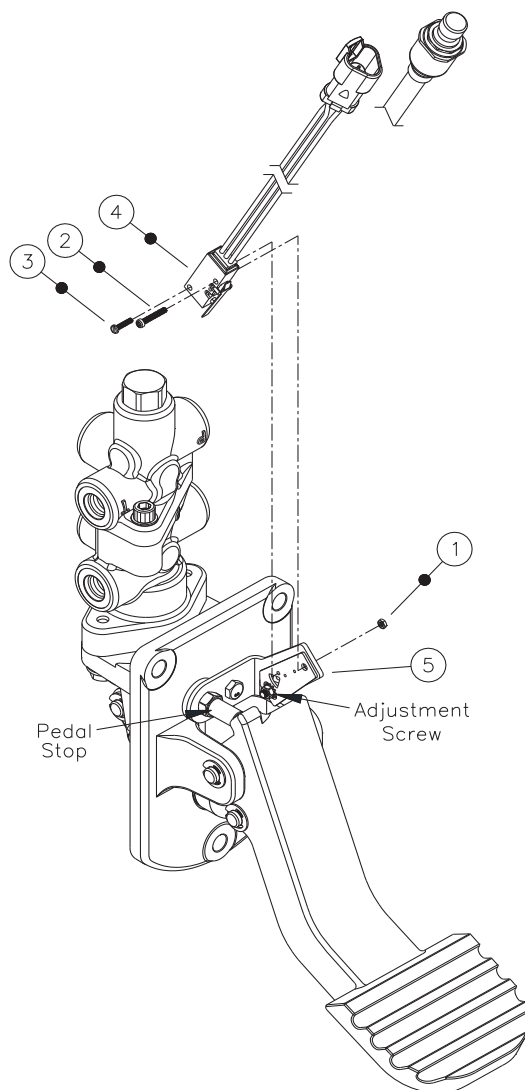

FIGURE 1

This publication is not subject to any update service. Information contained in this publication was in effect at the time the publication was approved for printing and is subject to change without notice or liability. ZF Off-Highway Solutions Minnesota Inc. reserves the right to revise the information presented or to discontinue the production of parts described at any time.



ZF Off-Highway Solutions Minnesota Inc.

1911 Lee Boulevard / North Mankato, MN U.S.A. 56003

Tel: +1 507 625 6426 Fax: +1 507 625 3212