

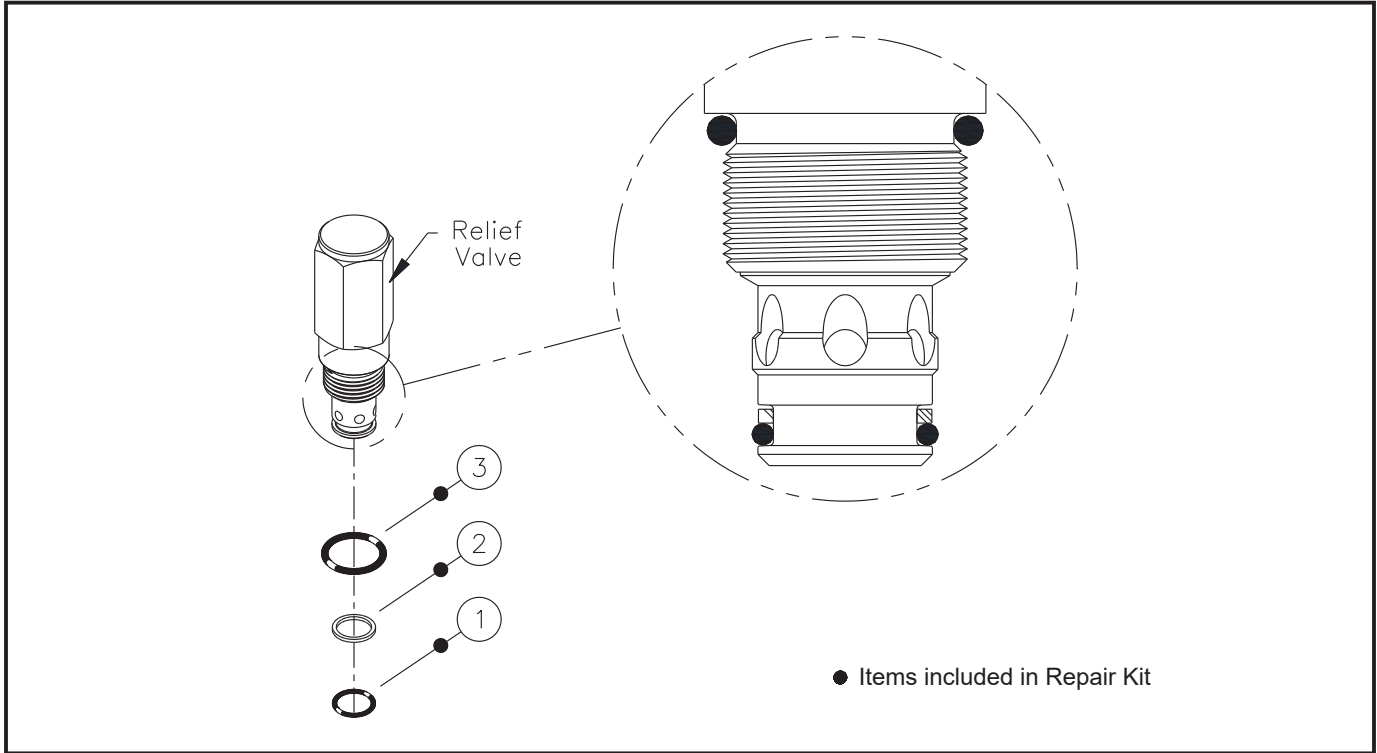

Service Instructions



⚠ WARNING

Relief valve is preset at the factory. DO NOT READJUST or system damage or failure may occur. If relief valve is not functioning properly, contact ZF Off-Highway Solutions Minnesota Inc. for a factory preset relief valve

SERVICE INSTRUCTIONS

⚠ CAUTION

Be sure energy is relieved from accumulator charging valve before servicing. See machine operating instructions for procedures to relieve system energy.

DISASSEMBLY

1. Remove relief valve from accumulator charging valve using hex flats.
2. Remove o-ring (1), back-up ring (2) and o-ring (3) from relief valve.

ASSEMBLY

1. Install new o-ring (3), new back-up ring (2) and new o-ring (1) on relief valve. Note order of o-rings and back-up ring.
2. Install relief valve in accumulator charging valve and torque 50.2-59.7 N·m (37-44 lb·ft) using hex flats.

This publication is not subject to any update service. Information contained in this publication was in effect at the time the publication was approved for printing and is subject to change without notice or liability. ZF Off-Highway Solutions Minnesota Inc. reserves the right to revise the information presented or to discontinue the production of parts described at any time.



ZF Off-Highway Solutions Minnesota Inc.
1911 Lee Boulevard / North Mankato, MN U.S.A. 56003
Tel: +1 507 625 6426 **Fax:** +1 507 625 3212