

SHIM KIT



Service Instructions

NOTE

This kit is to be used to increase the charge valve pressure setting. Shims (4) can wear and cause low charge pressure to drop below 98.6 bar (1430 PSI).

SERVICING PROCEDURES

⚠ CAUTION

To prevent contamination to the brake valve or hydraulic system, thoroughly clean brake valve and surrounding area of all dirt, grease, oil, etc. before servicing. Be sure machine hydraulic system energy is relieved before servicing the brake valve. See machine service manual for procedures to relieve system energy.

1. Remove plug (1) from housing (6). Remove o-ring (2) from plug (1).
2. Lubricate new o-ring (2) with clean system fluid and install on plug (1).
3. Along with existing shim(s) (4), add one additional new shim (4). Each new shim (4) added will increase pressure approximately 6.2 bar (90 PSI).
4. Reinstall plug (1) in housing (6) and torque 47.5 N·m (35 lb·ft).
5. Restart the system and check the accumulator pressures during a charge cycle. Accumulator pressures should cycle from 105.5 ± 6.9 bar (1530 \pm 100 PSI) to 202.7 ± 3.5 bar (2940 \pm 50 PSI).
6. If the charge cycle stalls at high pressure, the setting is greater than the pump pressure and one of the shims needs to be removed.

● Items included in Repair Kit

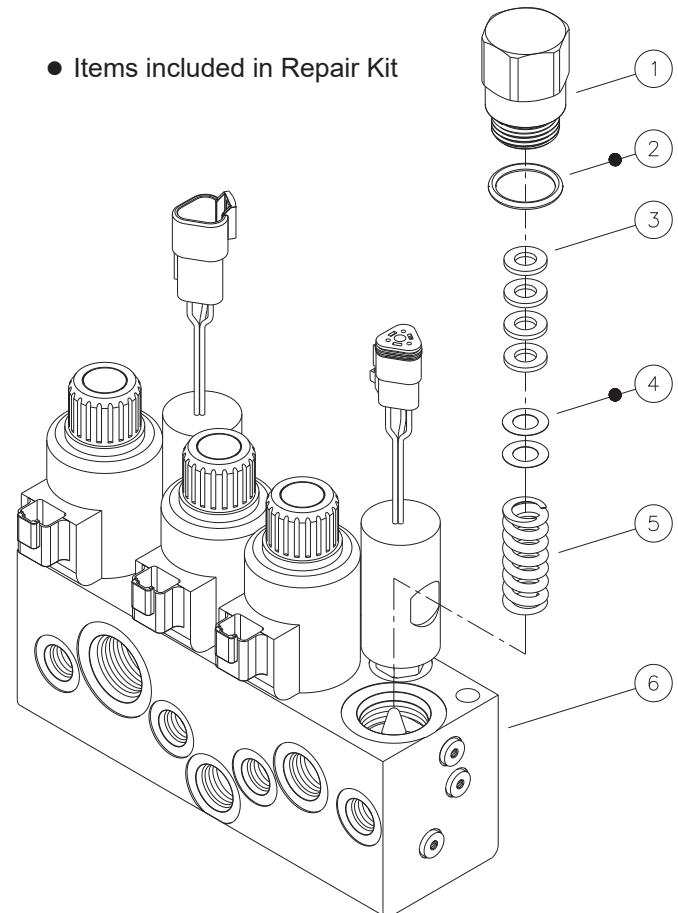

This publication is not subject to any update service. Information contained in this publication was in effect at the time the publication was approved for printing and is subject to change without notice or liability. ZF Off-Highway Solutions Minnesota Inc. reserves the right to revise the information presented or to discontinue the production of parts described at any time.



ZF Off-Highway Solutions Minnesota Inc.

1911 Lee Boulevard / North Mankato, MN U.S.A. 56003

Tel: +1 507 625 6426 Fax: +1 507 625 3212