

# MASTER CYLINDER



## Service Instructions

### DISASSEMBLY

1. Remove cylinder from vehicle. Do not attempt to repair the cylinder while it is installed on the vehicle. Drain fluid from cylinder.
2. Remove boot (1) and retaining ring (2) from housing (11). **NOTE: Retaining ring is under tension of spring (8).**
3. Remove washer (3) from housing bore.
4. Remove piston (5) from housing bore and then remove cup (4) from piston (5).
5. Remove cup (6) from housing bore.

6. Remove tapered spring (8) and attached retainer (7) from housing bore.
7. Remove check valve (9) from housing bore.
8. Remove seat (10) from housing bore.

### ASSEMBLY

1. Lubricate cup (4) with type fluid used in system and install on piston (5).
2. Insert seat (10) into housing bore.
3. Insert check valve (9) into housing bore.
4. Insert tapered spring (8) and attached retainer (7) into housing bore. **NOTE: Wide end of the spring must be inserted first.**
5. Lubricate cup (6) with type fluid used in system and then insert into housing bore. Note direction of cup.
6. Insert piston (5) into housing bore. Note direction of piston.
7. Insert washer (3) into housing bore.
8. Install retaining ring (2) and boot (1) on housing.

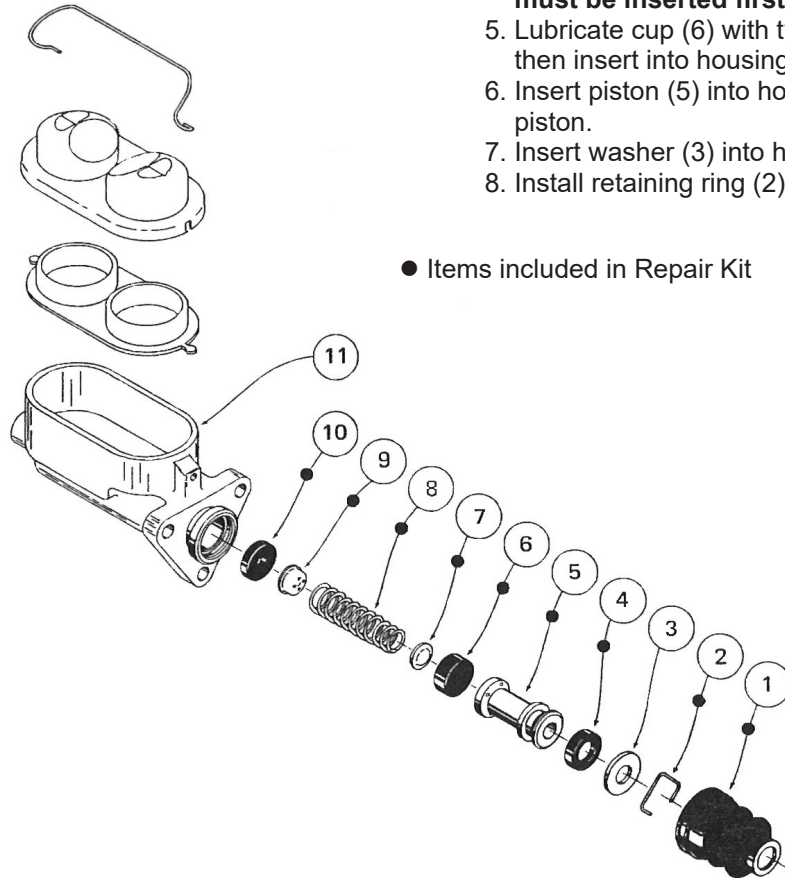

This publication is not subject to any update service. Information contained in this publication was in effect at the time the publication was approved for printing and is subject to change without notice or liability. ZF Off-Highway Solutions Minnesota Inc. reserves the right to revise the information presented or to discontinue the production of parts described at any time.

