

SEALING INFORMATION

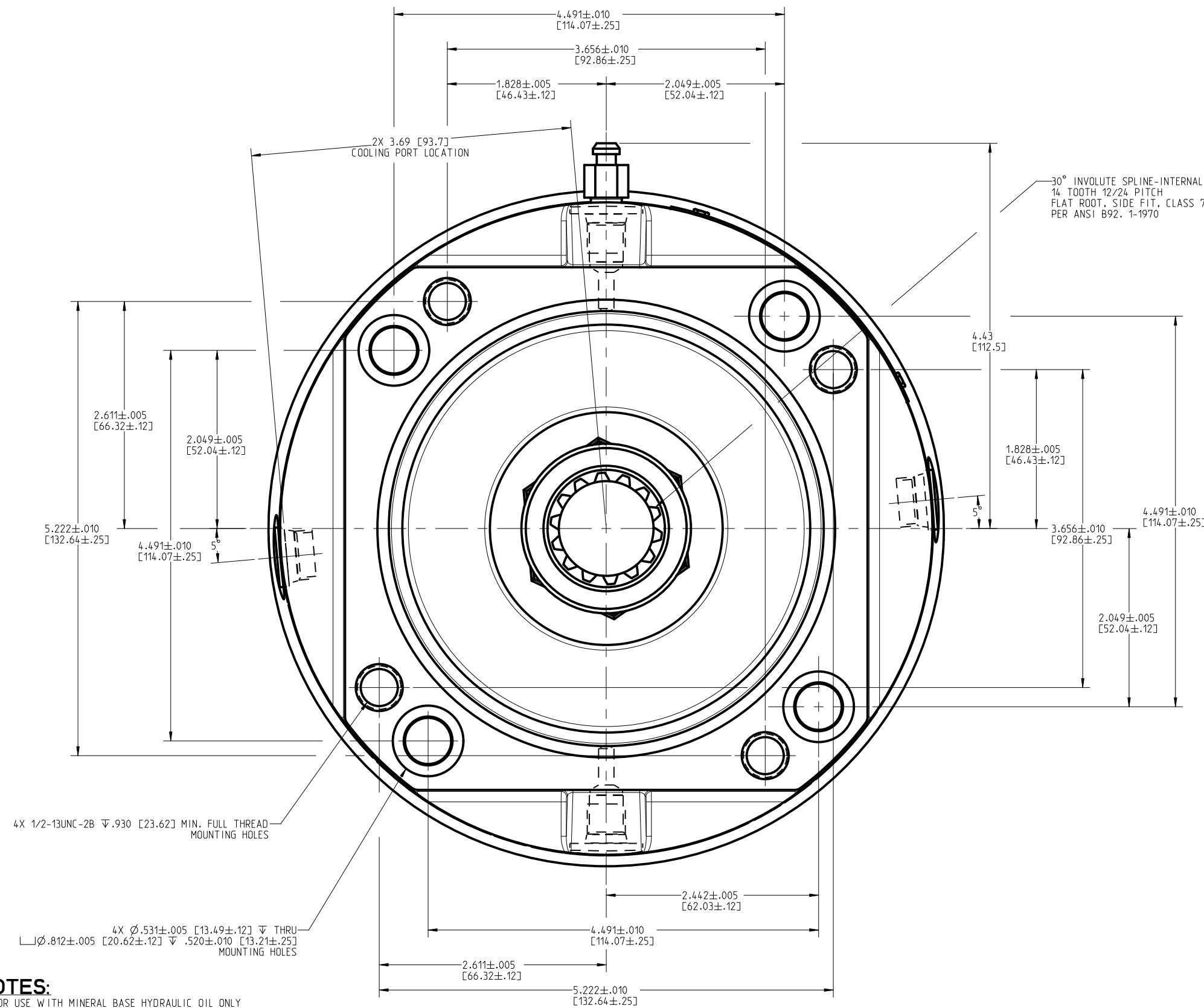
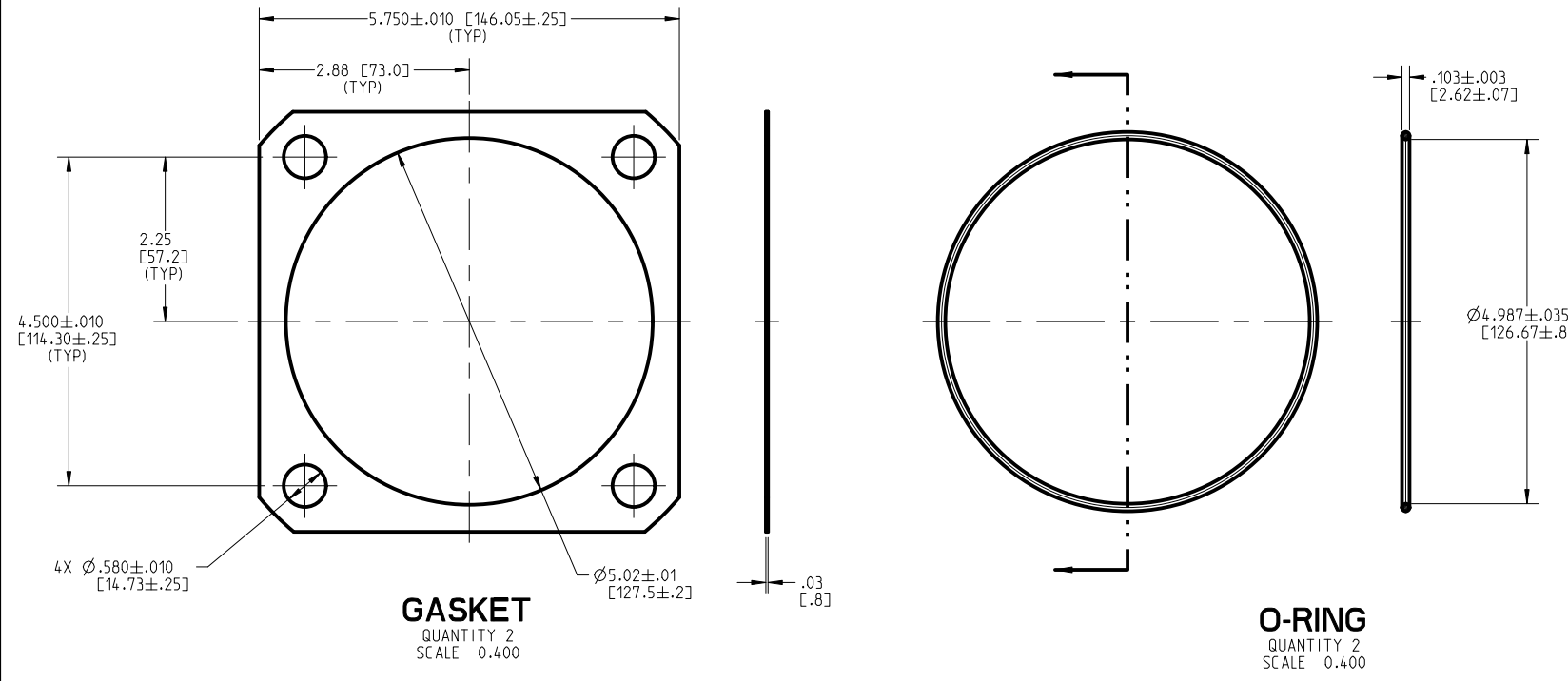

NOTES:

- FOR USE WITH MINERAL BASE HYDRAULIC OIL ONLY.
- DIMENSIONS WITHOUT TOLERANCE MAY VARY BETWEEN UNITS AND ARE FOR REFERENCE PURPOSES ONLY. MILLIMETER VALUES MAY NOT BE AN EXACT CONVERSION OF INCH VALUES.
- LINING REPAIR KIT P/N 12-501-004
- BEARING REPAIR KIT P/N 12-501-006
- O-RING REPAIR KIT P/N 12-501-002
- SPRING REPAIR KIT P/N 12-501-008
- BRAKE INCLUDES MOUNTING FACE GASKETS AND O-RINGS. DO NOT USE THE GASKET AND O-RING TOGETHER TO SEAL A MOUNTING FACE.
- BRAKE TO BE INSPECTED FOR DAMAGE TO INTERNAL PARTS AFTER EACH EMERGENCY DYNAMIC BRAKING EVENT PRIOR TO RETURNING TO NORMAL OPERATION.
- RECOMMEND USING GRADE 8 BOLTS AND APPROPRIATE WASHERS FOR INSTALLATION. TO PREVENT BINDING, RUN THE BOLTS IN ALTERNATIVELY UNTIL SNUG. TORQUE GRADE 8 BOLTS TO 80-90 LBFT. USE SUITABLE LOCTITE ON THE BOLT THREADS. WHEN BRAKE IS MOUNTED TO A MOTOR, ALL AVAILABLE HOLES MUST BE USED.

SPECIFICATIONS:

TYPE:	WET MULTIPLE DISC BRAKE, SPRING APPLY, HYDRAULIC RELEASE
TORQUE RATING:	WET 4,600 LBIN STATIC (BREAKAWAY) AT 0 PSI BACK PRESSURE DRY 7,000 LBIN DRY TORQUE FOR BRAKE RATING AND SPECIFICATIONS ONLY ACTUAL TORQUE MAY VARY BY UP TO 10% DUE TO MANUFACTURING TOLERANCES
RELEASE PRESSURE:	160 PSI INITIAL, 210 PSI FULL
MAXIMUM OPERATING PRESSURE:	3,000 PSI
MAXIMUM SPEED:	3,900 RPM
LINING MATERIAL:	SINTERED BRONZE
APPROXIMATE WEIGHT:	40 LB

COOLING OIL RECOMMENDATIONS

OIL TYPE:	MINERAL BASE HYDRAULIC OIL SUCH AS MOBIL DTE 24, CITGO A/W 32 OR EQUIVALENT
FLOW THRU CAPACITY:	1.0 - 7.0 GPM
MAXIMUM CASE PRESSURE:	15 PSI
SUMP OIL VOLUME:	HORIZONTAL SHAFT: 4 FL. OZ. VERTICAL SHAFT: CONTACT FACTORY

INCH
(MILLIMETER)



COMPONENT AND SYSTEM RECOMMENDATIONS MADE BY MICO, INC. ARE BASED ON INFORMATION SUPPLIED BY POTENTIAL USER AND/OR SYSTEM DESIGNER. THE POTENTIAL USER AND/OR DESIGNER MUST MAKE FINAL ACCEPTANCE AND APPROVAL OF COMPONENTS AND SYSTEM AFTER TESTING PERFORMANCE ON AN ACTUAL APPLICATION FOR WHICH SYSTEM WAS DESIGNED.

MICO, INC. CLAIMS PROPRIETARY RIGHTS TO THE MATERIAL DISCLOSED IN THIS DOCUMENT. THIS DOCUMENT IS PROVIDED IN CONFIDENCE AND MAY NOT BE REPRODUCED OR DISCLOSED WITHOUT WRITTEN PERMISSION FROM MICO, INC. COPYRIGHT MICO, INC. ALL RIGHTS RESERVED.

SCALE 0.750	TITLE MULTIPLE DISC BRAKE	SIZE C	DRAWING NUMBER 13-547-508	REV D
DWN MG 2018-01-27	APVD PROD ENGRG MG 2018-04-26			
X NO X7648	APVD ENGRG CL 2018-01-27			