

NAME		PEDAL TANDEM MODULATING VALVE		PART NO. 06-466-234	
LET.	E. C. O. NO.	OR CHANGE	AUTH	DATE	
A	N. P. R.		X5062		

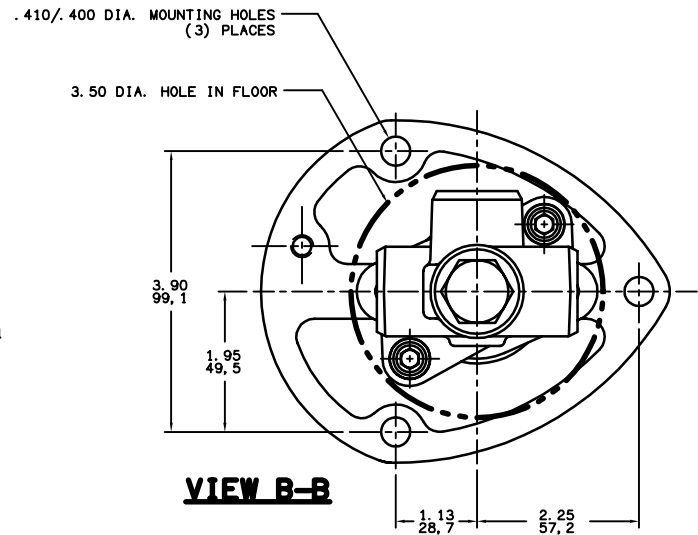
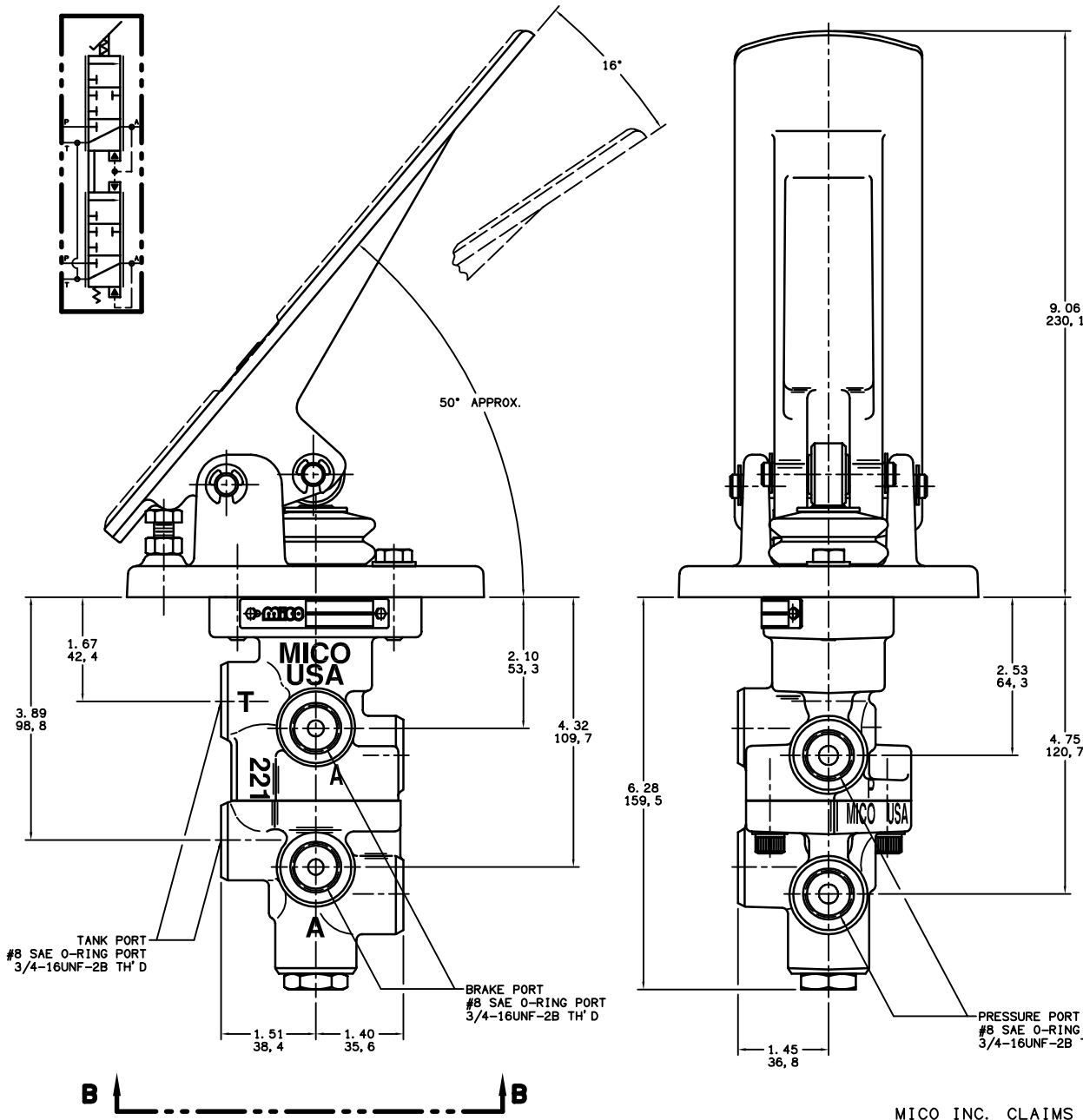

NOTES:

- 1) TO BE USED WITH MINERAL BASE HYDRAULIC OIL ONLY.
- 2) DIMENSIONS MAY VARY SLIGHTLY BETWEEN UNITS AND ARE TO BE USED FOR REFERENCE PURPOSES ONLY.
- 3) PEDAL AND BASE ASSEMBLY P/N 29-910-011.
- 5) VALVE ASSEMBLY P/N 20-100-593.
- 8) REPAIR KIT P/N 06-400-152.

PERFORMANCE CHARACTERISTICS:

- 1) BRAKE PRESSURE SETTING IS 350-450 PSI.
- 2) PRESSURE FROM UPPER BRAKE PORT IS APPROXIMATELY 30 PSI HIGHER THAN PRESSURE FROM LOWER BRAKE PORT.

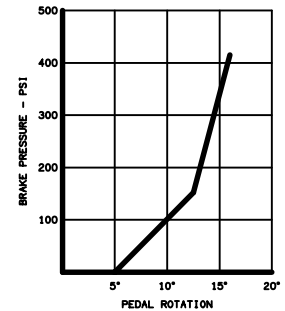

inches
millimeters

COMPONENT AND SYSTEM RECOMMENDATIONS MADE BY MICO, INC. ARE BASED ON INFORMATION SUPPLIED BY POTENTIAL USER AND/OR SYSTEM DESIGNER. THE POTENTIAL USER AND/OR DESIGNER MUST MAKE FINAL ACCEPTANCE AND APPROVAL OF COMPONENTS AND SYSTEM AFTER TESTING PERFORMANCE ON AN ACTUAL APPLICATION FOR WHICH SYSTEM WAS DESIGNED.

MICO INC. CLAIMS PROPRIETARY RIGHTS TO THE MATERIAL DISCLOSED IN THIS DOCUMENT. THIS DOCUMENT IS PROVIDED IN CONFIDENCE AND MAY NOT BE REPRODUCED OR DISCLOSED WITHOUT WRITTEN PERMISSION FROM MICO INC. COPYRIGHT MICO INC. ALL RIGHTS RESERVED.

MICO
INCORPORATED
North Mankato, Minnesota U. S. A.

CHECKED	DRAWING NO.	REV.
APPROVED ENG.	06-466-234 CUSTOMER COPY	A
DRAWN: CL	SCALE: NONE	DATE: 4-9-96