

DRAWING NUMBER
06-460-690
NPI OR ECN NO
ECN A000595

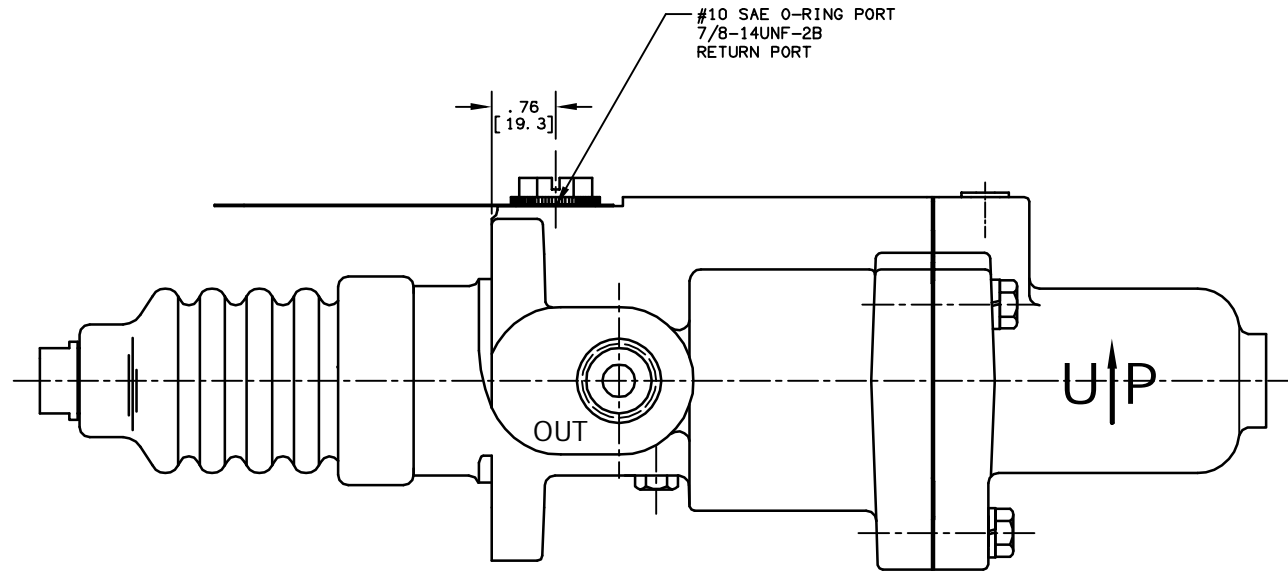

ATTENTION!
This is a #10 SAE O-ring Port
DO NOT USE PIPE FITTINGS

TOP VIEW OF TAG

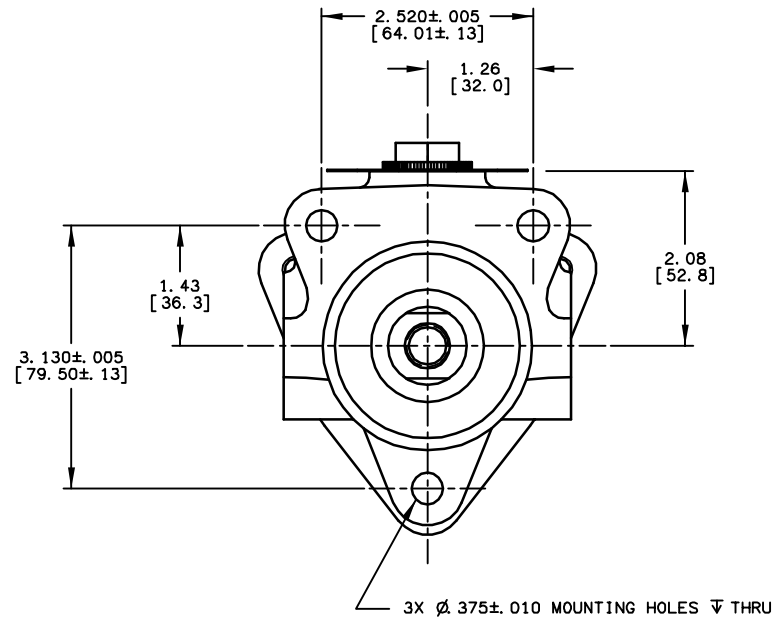
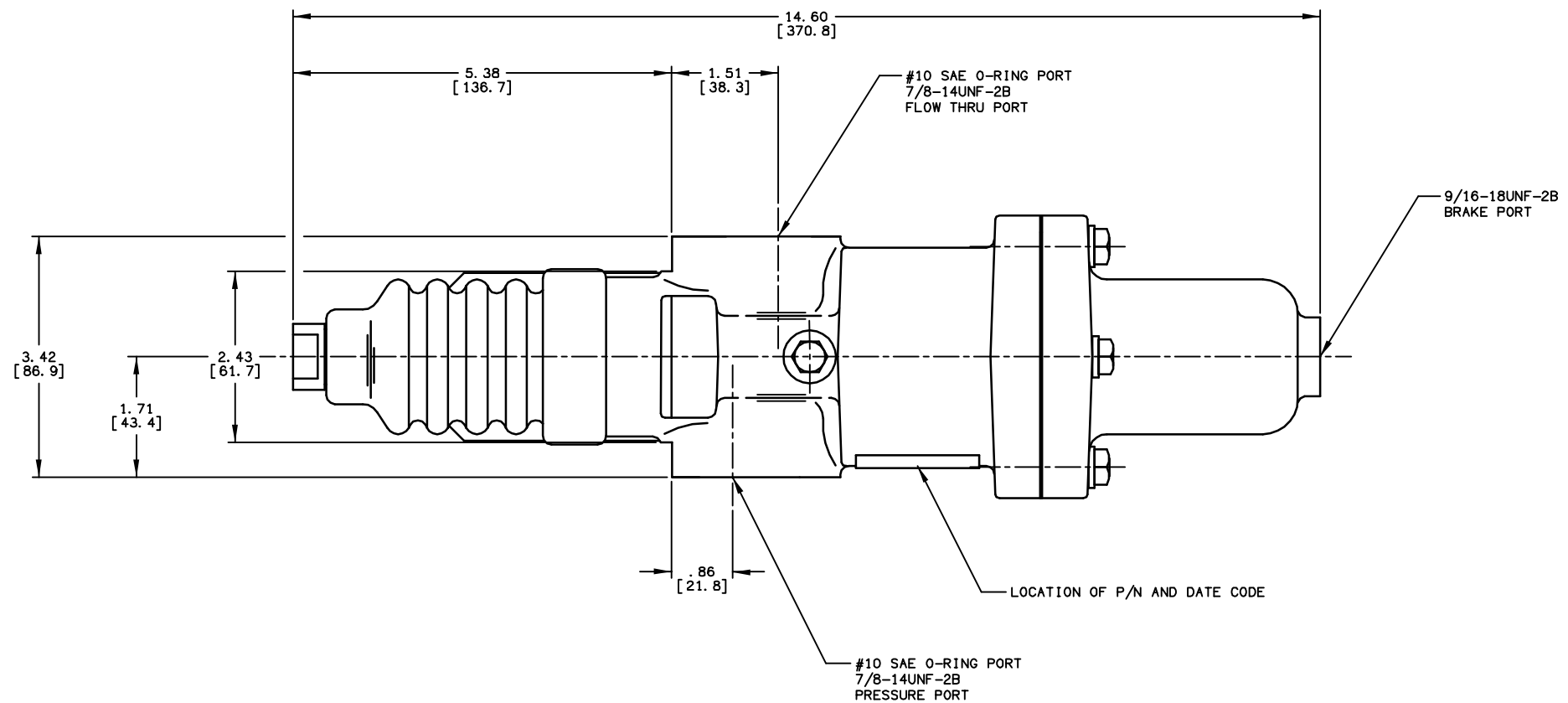

INCH
[MILLIMETER]

NOTES:

- 1) FOR USE WITH MINERAL BASED HYDRAULIC OIL ONLY.
- 2) DIMENSIONS WILL VARY SLIGHTLY BETWEEN UNITS AND ARE TO BE USED FOR REFERENCE PURPOSES ONLY. MILLIMETER VALUES MAY NOT BE AN EXACT CONVERSION OF INCH VALUES
- 3) VALVE MUST BE MOUNTED WITH RETURN PORT ON TOP.
- 4) APPROXIMATE WEIGHT OF ASSEMBLY: 14.5 LBS.
- 5) REPAIR KIT P/N 06-459-010.

PERFORMANCE CHARACTERISTICS:

- 1) POWER BRAKING PRESSURE 1650-1750 PSI WITH 385 LBS. LINK FORCE AND 845 PSI AT PRESSURE PORT. LINK STROKE .206-.240 NOM.
- 2) MECHANICAL BRAKING-LINK FORCE 1250 LBS. AT 600 PSI BRAKE PRESSURE. FULL LINK STROKE 1.760-1.928.
- 3) MASTER PISTON STROKE: 1.557-1.655.
- 4) PRESSURE DROP: 25 PSI AT 8 GPM.
- 5) FLOW RANGE: 3-24 GPM.
- 6) ADJUST BRAKES FOR .770 IN. MIN. MECHANICAL LINK STROKE TO BULD UP 100 PSI BRAKE PRESSURE.



COMPONENT AND SYSTEM RECOMMENDATIONS MADE BY MICO, INC ARE BASED ON INFORMATION SUPPLIED BY POTENTIAL USER AND/OR SYSTEM DESIGNER. THE POTENTIAL USER AND/OR DESIGNER MUST MAKE FINAL ACCEPTANCE AND APPROVAL OF COMPONENTS AND SYSTEM AFTER TESTING PERFORMANCE ON AN ACTUAL APPLICATION FOR WHICH SYSTEM WAS DESIGNED.

MICO, INC CLAIMS PROPRIETARY RIGHTS TO THE MATERIAL DISCLOSED IN THIS DOCUMENT. THIS DOCUMENT IS PROVIDED IN CONFIDENCE AND MAY NOT BE REPRODUCED OR DISCLOSED WITHOUT WRITTEN PERMISSION FROM MICO, INC. COPYRIGHT MICO, INC. ALL RIGHTS RESERVED.

SCALE .4375	TITLE OPEN CENTER POWER BRAKE VALVE	SIZE B	DRAWING NUMBER 06-460-690	REV E
DWN LAM 8-5-04	APVD PROD ENGRG	B	CUSTOMER COPY	
X NO X7200	APVD ENGRG BSW			