

VIEW A-A

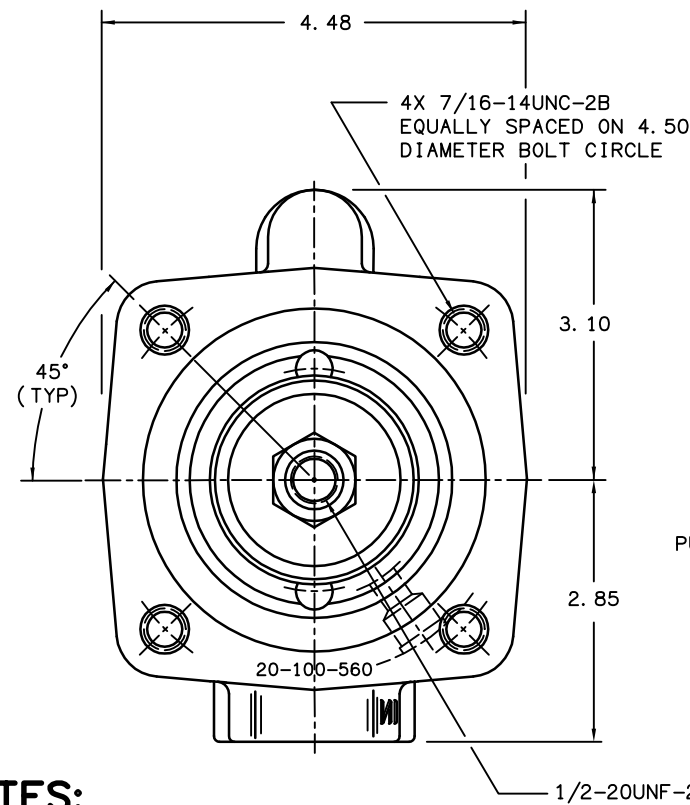

NOTES:

1. BOOSTER SECTION FOR USE WITH MINERAL BASE HYDRAULIC OIL ONLY.
2. BOOSTER SECTION REPAIR KIT P/N 02-400-076.
3. MASTER CYLINDER SECTION FOR USE WITH MINERAL BASE HYDRAULIC OIL ONLY.
4. MASTER CYLINDER SECTION REPAIR KIT P/N 02-400-243.
5. DIMENSIONS MAY VARY BETWEEN UNITS AND ARE FOR REFERENCE PURPOSES ONLY. MILLIMETER VALUES MAY NOT BE AN EXACT CONVERSION OF INCH VALUES.
6. SURFACE COATING: 90 GLOSS BLACK PAINT.

PERFORMANCE CHARACTERISTICS:

MASTER CYLINDER SECTION OUTPUT PRESSURE:
900±50 PSI @ 10 GPM

RELIEF VALVE PRESSURE (BOOSTER SECTION):
320±10 PSI @ 10 GPM @ 120°
FAHRENHEIT OIL TEMPERATURE.

INPUT FORCE (POWER) APPROX.:
490 LBS @ 900 PSI

FLUID DISPLACEMENT:
1.62 CUIN PRIMARY
1.62 CUIN SECONDARY

PUSH ROD TRAVEL:
1.62 IN

PUSH ROD ANGLE
4° MAX.

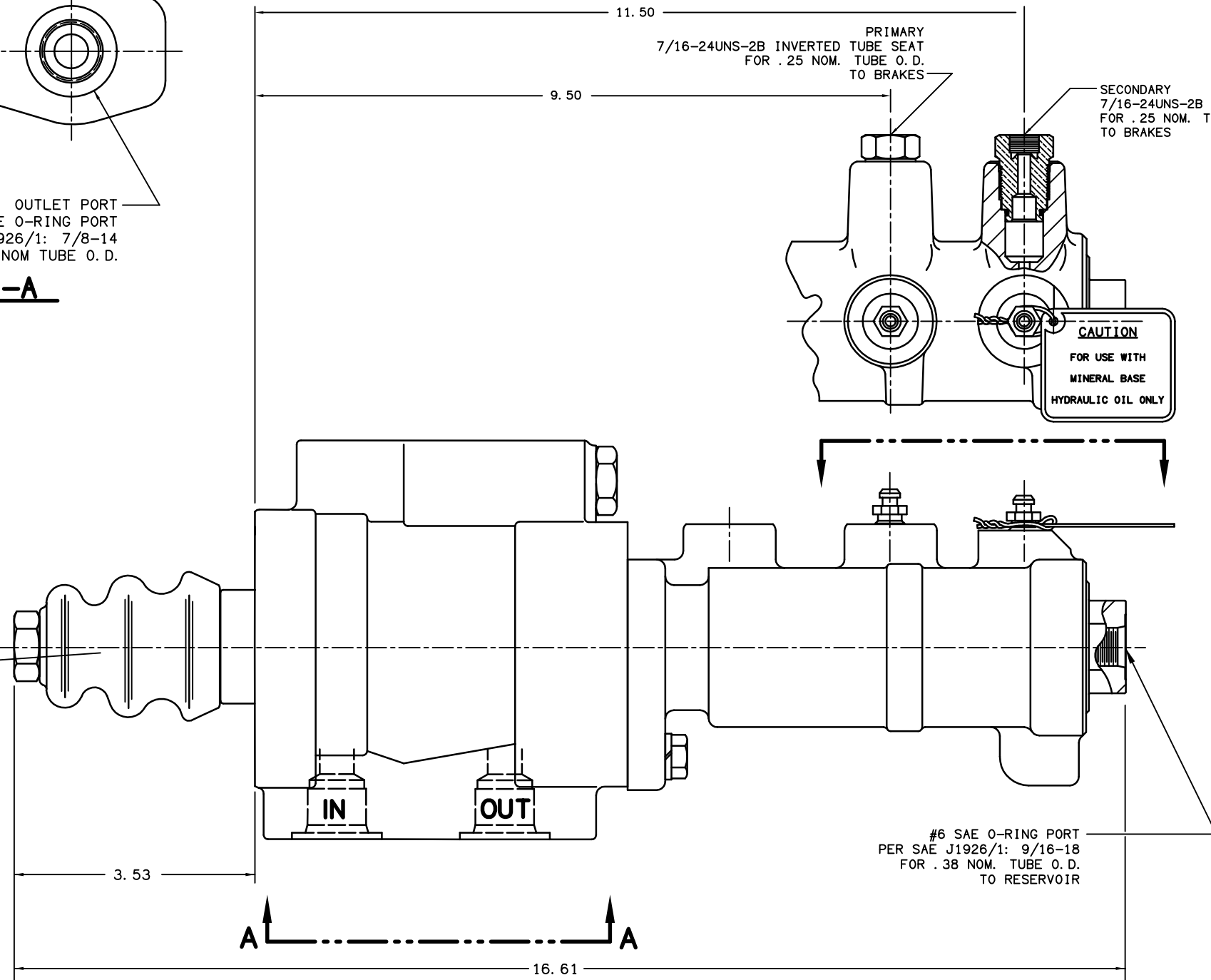

COMPONENT AND SYSTEM RECOMMENDATIONS MADE BY MICO, INC ARE BASED ON INFORMATION SUPPLIED BY POTENTIAL USER AND/OR SYSTEM DESIGNER. THE POTENTIAL USER AND/OR DESIGNER MUST MAKE FINAL ACCEPTANCE AND APPROVAL OF COMPONENTS AND SYSTEM AFTER TESTING PERFORMANCE ON AN ACTUAL APPLICATION FOR WHICH SYSTEM WAS DESIGNED.		MICO, INC CLAIMS PROPRIETARY RIGHTS TO THE MATERIAL DISCLOSED IN THIS DOCUMENT. THIS DOCUMENT IS PROVIDED IN CONFIDENCE AND MAY NOT BE REPRODUCED OR DISCLOSED WITHOUT WRITTEN PERMISSION FROM MICO, INC. COPYRIGHT MICO, INC. ALL RIGHTS RESERVED.		SCALE 1/2-1	TITLE TWO FLUID POWER BRAKE VALVE	SIZE B	DRAWING NUMBER 02-460-645	REV B
DWN JRA 2011-01-06	APVD PROD ENGRG DPD 2011-01-10	X NO 09-3015	APVD ENGRG BSW 2011-01-07				CUSTOMER COPY	