

COLLAR AND CAP SCREW MUST BE REMOVED BEFORE USE. PRESSURIZE TO 1000 PSI MIN. 2000 PSI MAX.

LINING WEAR INDICATOR

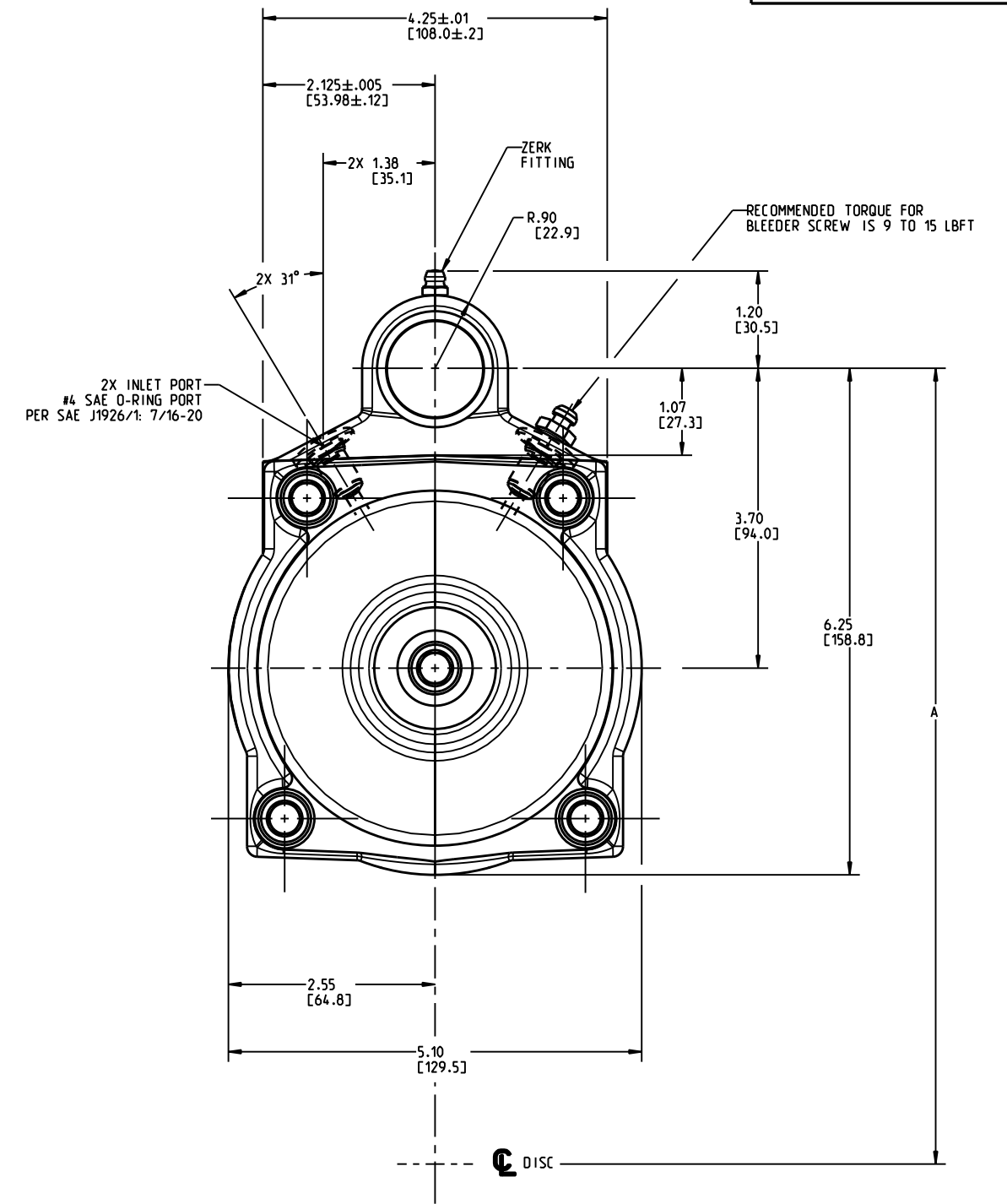

NOTES:

- 1) TO BE USED WITH MINERAL BASE HYDRAULIC OIL ONLY.
- 2) DIMENSIONS MAY VARY SLIGHTLY BETWEEN UNITS AND ARE TO BE USED FOR REFERENCE PURPOSES ONLY. MILLIMETER VALUES MAY NOT BE AN EXACT CONVERSION OF INCH VALUES.
- 3) APPLY A POLYMER BASE MOLY GREASE THRU ZERK FITTING AFTER ASSEMBLY UNTIL GREASE IS OBSERVED EXITING SEALS.
- 4) BRAKE SHOWN IN THE APPLIED POSITION.
- 5) BRAKE SURFACE FINISH: ZINC CHROMATE YELLOW PER ASTM B633, TYPE II, SC2
- 6) LINING MATERIAL: NON-ASBESTOS, LEAD FREE
- 7) COLLAR TOOL AND CAP SCREW MUST BE REMOVED AFTER INSTALLATION OF BRAKE BY CUSTOMER.
- 8) SEAL KIT: 02-500-185
- 9) REPAIR KIT: 02-500-166
- 10) LINING KIT: 20-060-092

PERFORMANCE CHARACTERISTICS:

- 1) BRAKE TORQUE IN NEW LINING CONDITION: Bf (IN-LB) = 6.225 X (DISC RADIUS - 1.31).
- 2) BRAKE TORQUE IN WORN LINING CONDITION: Bf (IN-LB) = 4.895 X (DISC RADIUS - 1.31)
- 3) MAXIMUM BRAKE TORQUE ACHIEVED ONLY AFTER BRAKE HAS BEEN PROPERLY BURNISHED.
- 4) NOMINAL PISTON TRAVEL FROM NEW TO WORN LINING CONDITION: 0.300 INCHES.
- 5) COMPLETE RETRACTION PRESSURE: 1,000 PSI.
- 6) CONTINUOUS DUTY PRESSURE: 2,000 PSI.
- 7) INTERMITTENT DUTY PRESSURE: 2,500 PSI.
- 8) VOLUME REQUIRED FOR COMPLETE RETRACTION: 4.53 CU IN.
- 9) CAUTION: DISC RUBBING SPEED SHOULD NOT EXCEED 5,000 FT./MIN.
- 10) "A" DIMENSION = DISC RADIUS + 2.38 INCHES.

INCH
[MILLIMETER]



COMPONENT AND SYSTEM RECOMMENDATIONS MADE BY MICO, INC ARE BASED ON INFORMATION SUPPLIED BY POTENTIAL USER AND/OR SYSTEM DESIGNER. THE POTENTIAL USER AND/OR DESIGNER MUST MAKE FINAL ACCEPTANCE AND APPROVAL OF COMPONENTS AND SYSTEM AFTER TESTING PERFORMANCE ON AN ACTUAL APPLICATION FOR WHICH SYSTEM WAS DESIGNED.		MICO, INC CLAIMS PROPRIETARY RIGHTS TO THE MATERIAL DISCLOSED IN THIS DOCUMENT. THIS DOCUMENT IS PROVIDED IN CONFIDENCE AND MAY NOT BE REPRODUCED OR DISCLOSED WITHOUT WRITTEN PERMISSION FROM MICO, INC. COPYRIGHT MICO, INC. ALL RIGHTS RESERVED.		SCALE 0.500	TITLE SPRING BRAKE		
DWN CL 2008-06-13	APVD PROD ENGRG	SIZE B	DRAWING NUMBER 01-530-904	REV A	CUSTOMER COPY		
X NO 08-2152	APVD ENGRG BSW 2008-06-25			2	2		